



**1710/648 Lonsdale Street Melbourne VIC**

2  2 

Completed just over a year ago, this sleek two-bedroom, two-bathroom residence delivers contemporary urban living in the landmark West Side Place development ? one of Melbourne's most prestigious new addresses.

**Type** : Apartment

**View** : <https://www.frederickproperty.com.au/sale/vic/inner-city/melbourne/residential/apartment/8536967>

**Features:**

- Two spacious bedrooms with built-in robes and floor-to-ceiling glazing
- Two designer bathrooms with premium fittings and sleek finishes
- Light-filled open-plan living and dining zone with elevated city outlooks
- Contemporary kitchen with stone benchtops, quality appliances and ample storage
- Ducted heating/cooling and double-glazed windows for



**Fred Liu**  
03 9889 1118



**Cassie Gu**  
03 9889 1118

[For full version visit the website](https://www.frederickproperty.com.au)

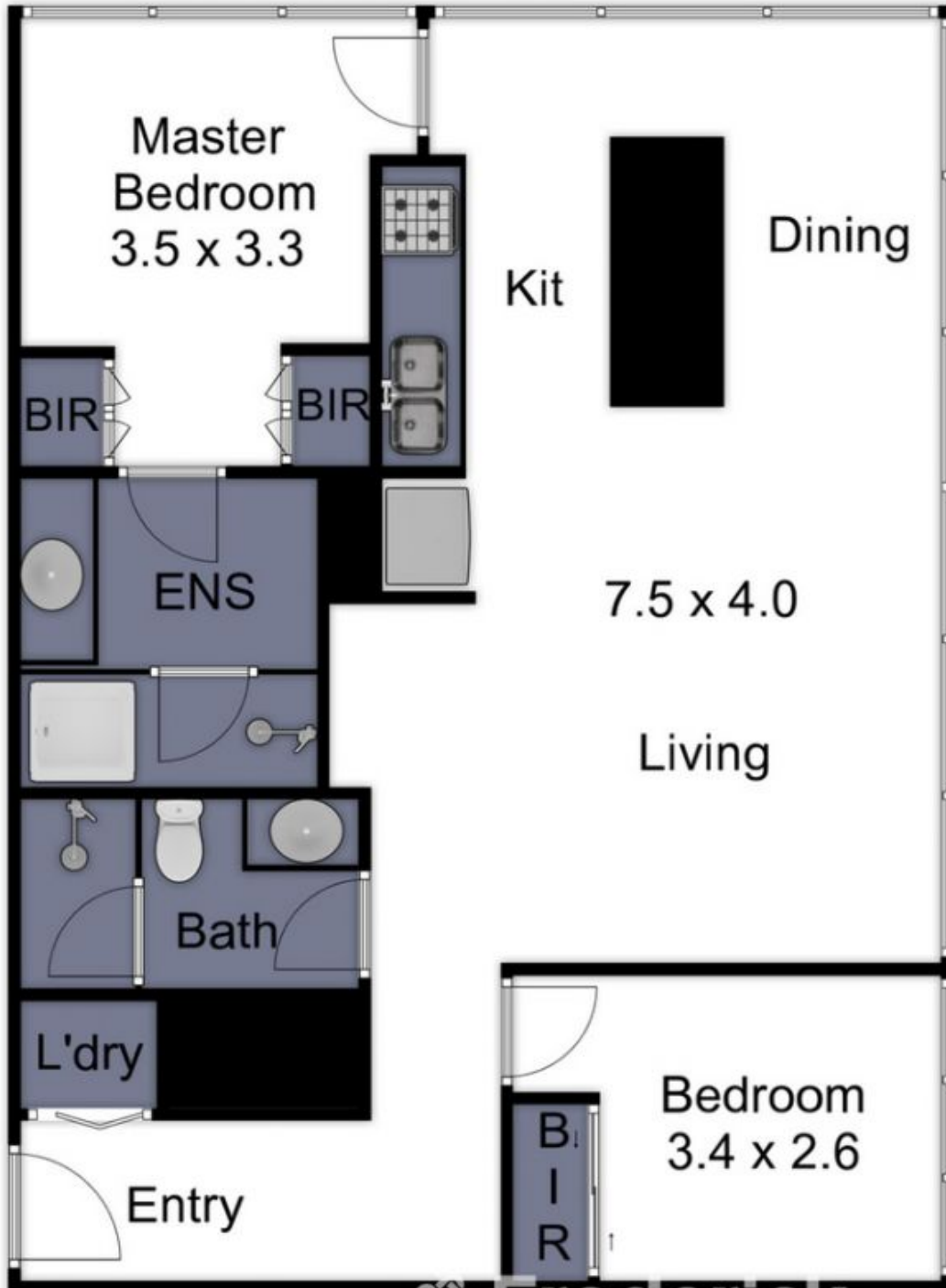

## 1710/648 Lonsdale St, Melbourne

THIS FLOOR PLAN IS A SKETCH ALL DATA SHOWN IS GENERAL ONLY.  
NB: ALL DIMENSIONS STATED ARE APPROXIMATE ONLY  
AND SHOULD NOT BE TAKEN AS DEFINITE.