



13 Laxdale Road Camberwell VIC

4 🚗 2 🚗 3 🚗

Opportunities to redevelop on a large allotment in this area or renovate and update a captivating Californian of this size are rare and highly sought-after with its attractive façade and street presence (STCA).

Complemented by a quiet cul-de-sac position in a family-friendly area moments from Lynden Park, close to Through Road Reserve and either Highfield or Wattle Parks, public transport options, an excellent array of both private and public schools, including walking distance to the highly regarded Hartwell Primary; plus numerous surrounding shopping options, including the popular Leo's Fine Food Supermarket, Burwood Village Shopping district.

The accommodation over single level features period attributes including high decorative 3 meter ceilings and coloured leadlight glass with a central open kitchen and

Land Size : 849.5 sqm
View : <https://www.frederickproperty.com.au/sale/vic/east/camberwell/residential/house/7156787>



Fred Liu
03 9889 1118

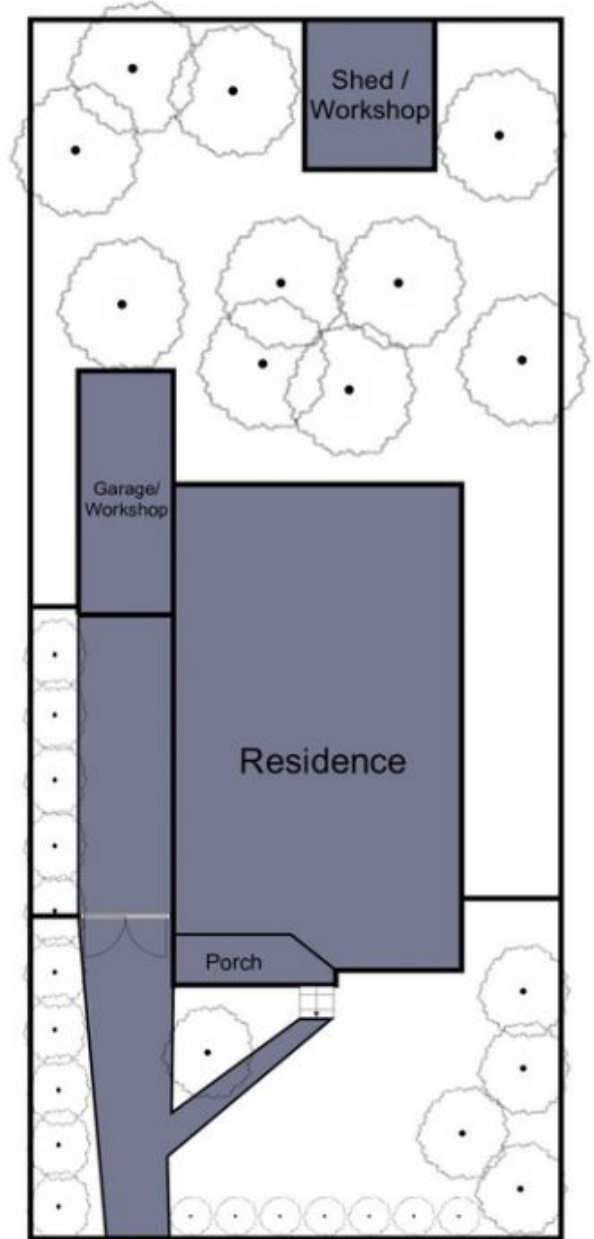

13 Laxdale Road Camberwell

THIS FLOOR PLAN IS A SKETCH ALL DATA SHOWN IS GENERAL ONLY.
NB: ALL DIMENSIONS STATED ARE APPROXIMATE ONLY
AND SHOULD NOT BE TAKEN AS DEFINITE.

