

20 Reserve Avenue Mitcham VIC

4 🚗 2 🚚 6 🚗

Renovated to perfection, this stunning home has been reimagined for modern day living with first class finishes and a focus on family enjoyment across its sleek layout with twin outdoor entertaining zones and tranquil placement beside a delightful reserve.

Land Size : 704 sqm
View : <https://www.frederickproperty.com.au/lease/vic/east/mitcham/residential/house/7120662>

Blurring the lines between inside the out, the open plan lounge and dining room flows over streamlined floorboards and encompasses an electric fireplace and sliding doors that open effortlessly out onto a north-facing entertainer's patio with reserve aspects.



Fred Liu
03 9889 1118

The high-end kitchen accompanies this space and creates a haven for your culinary delights, complete with waterfall stone benches, a full-complement of Miele appliances including a gas stove, rangehood, oven and dishwasher, plus an island breakfast bench and soft close cabinetry.

20 Reserve Avenue MITCHAM

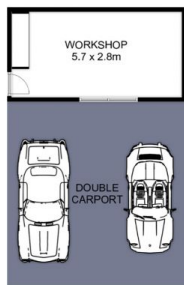
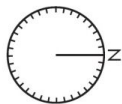

INT : 160m²
EXT : 113m²
TOTAL : 273m²

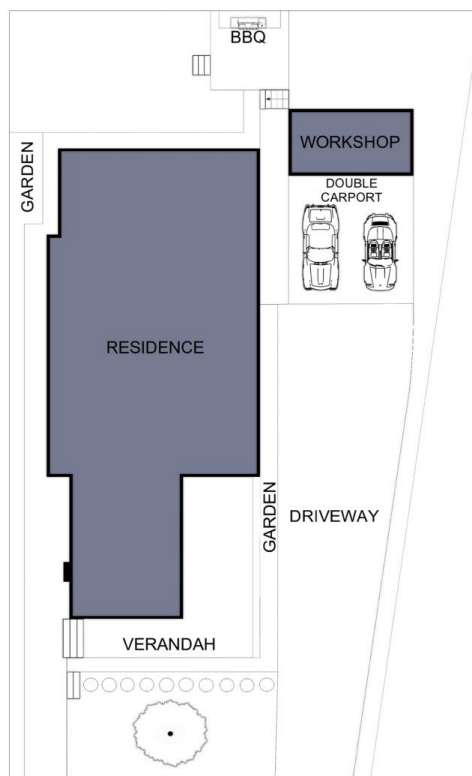

For information only. Dimensions are approximate. All information contained herein is gathered from sources we believe to be reliable. However, we cannot guarantee its accuracy and interested persons should rely on their own enquiries.