





## 20 Reserve Avenue Mitcham VIC

4  2  6 

Renovated to perfection, this stunning home has been reimagined for modern day living with first class finishes and a focus on family enjoyment across its sleek layout with twin outdoor entertaining zones and tranquil placement beside a delightful reserve.

Blurring the lines between inside the out, the open plan lounge and dining room flows over streamlined floorboards and encompasses an electric fireplace and sliding doors that open effortlessly out onto a north-facing entertainer's patio with reserve aspects.

The high-end kitchen accompanies this space and creates a haven for your culinary delights, complete with waterfall stone benches, a full-complement of Miele appliances including a gas stove, rangehood, oven and dishwasher, plus an island breakfast bench and soft close cabinetry.

**Price** : \$ 1,480,000  
**Land Size** : 704 sqm  
**View** : <https://www.frederickproperty.com.au/sale/vic/east/mitcham/residential/house/6982603>



**Fred Liu**  
03 9889 1118



**Aaron Wang**  
03 9889 1118

# 20 Reserve Avenue MITCHAM

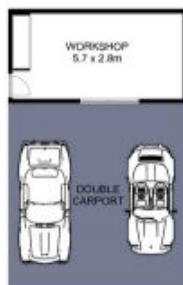

INT : 160m<sup>2</sup>  
EXT : 113m<sup>2</sup>  
TOTAL : 273m<sup>2</sup>

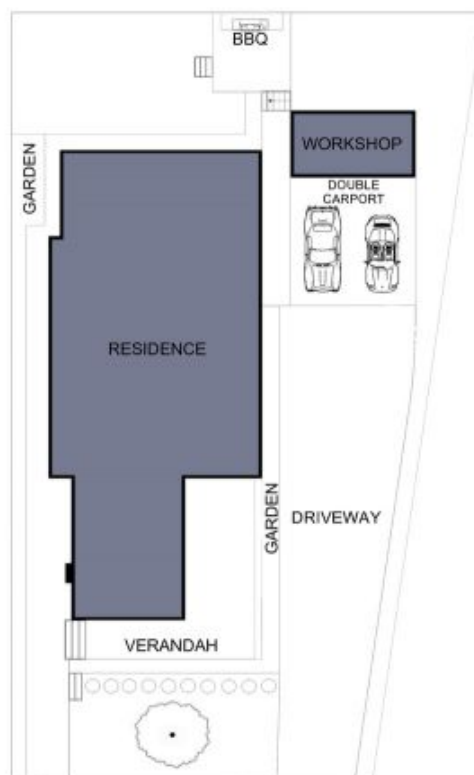

Indicative only. Dimensions are approximate. All information contained herein is gathered from sources we believe to be reliable. However, we cannot guarantee its accuracy and interested persons should rely on their own enquiries.